

Place filled with rich air

PLAZA FACILITIES

Welcome to Keio Plaza Hotel Sapporo.

We value the encounters between people who gather here and come and go. We welcome each guest with sincerity.

We love Hokkaido and Sapporo. Here at the hotel, we will share these unknown charms with our guests, and help them develop the uniqueness of Hokkaido.

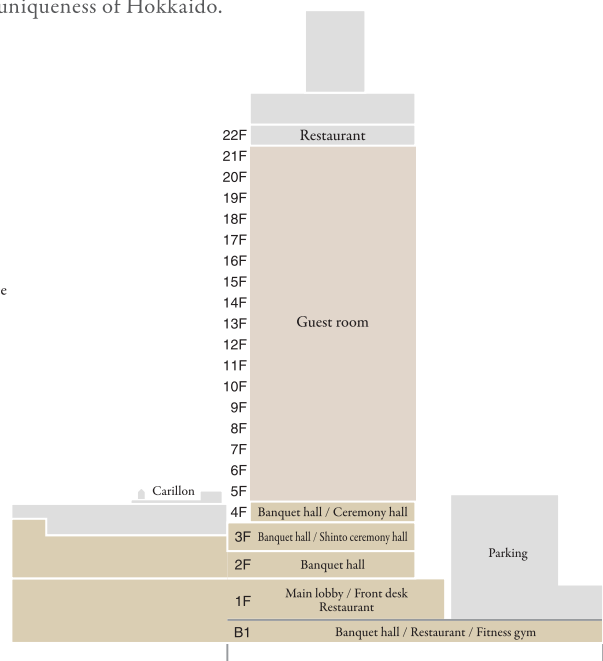
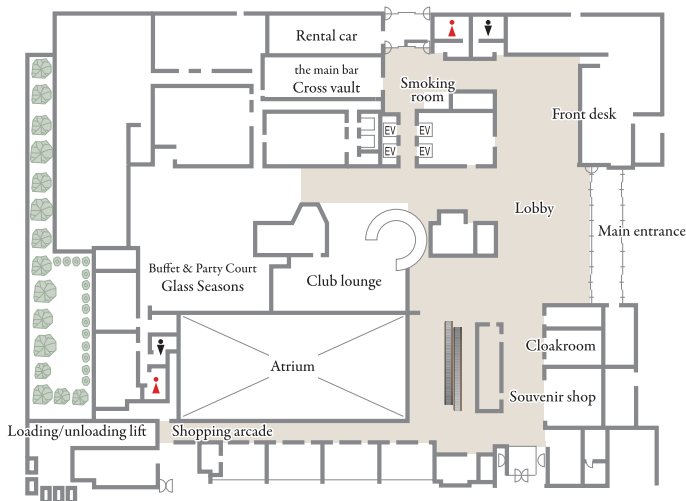

Membership Sports & Fitness

PENT SEPT

(Pool / Gym)

B1 [Business hours]
10:00-22:00 (pool/gym open until 21:00)

[Regular holiday]
10th of every month

※Available only to those over 16 years old

The extremely clear pool uses natural groundwater and undergoes strict water quality control. We offer private lessons and aqua programs. You can get serious exercise using Technogym, an Italian fitness brand chosen as the official training equipment supplier for international competitions. Enjoy a hotel-quality, fulfilling gym life.



Wireless LAN (Wi-Fi) connection is available on all floors. (free)
Wired LAN connection is possible in guest rooms and banquet halls.



Parking information

Equipped with an all-weather parking lot.
Regardless of the season or weather, it has 24-hour entry and exit and parking for 300 vehicles.



KEIO PLAZA HOTEL SAPPORO

21F

Luxury Floor

A high-quality space and sophisticated design that allows you to relax and enjoy your stay even during a long stay.
The top floor guest room boasts a spectacular view.

Imperial suite 1room

Room size/133.6㎡ Bed size/120cm×203cm

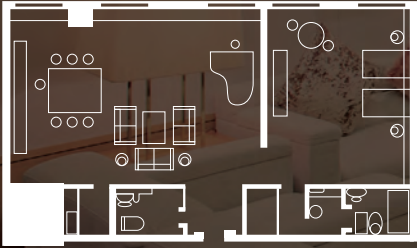

Luxury sweet double 2rooms

Room size/58.1㎡
Bed size/180cm×200cm

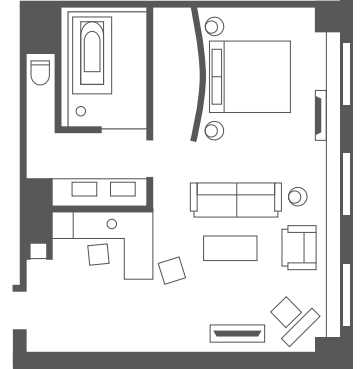

Luxury sweet twin typeA 1room

Room size/54.2㎡
Bed size/120cm×200cm



Luxury corner sweet (4beds) 2rooms

Room size/62.9㎡
Bed size/120cm×200cm



21F Luxury Floor

An open bathroom with a magnificent view.
Three types of interior spaces full of luxury create an extraordinary feel.



View bath suite European

**View bath suite
European** 1room
Room size/59.3㎡
Bed size/120cm×200cm

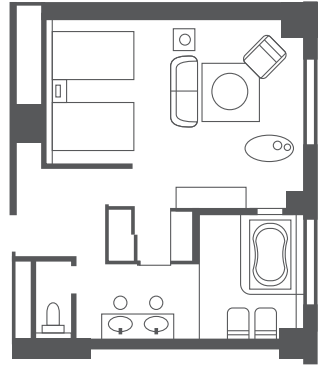

View bath suite Italian

**View bath suite
Italian** 1room
Room size/54.6㎡
Bed size/180cm×200cm

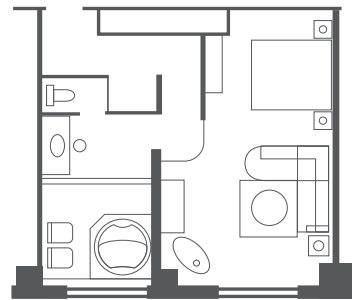

View bath suite New York

**View bath suite
New York** 1room
Room size/57.9㎡
Bed size/120cm×200cm

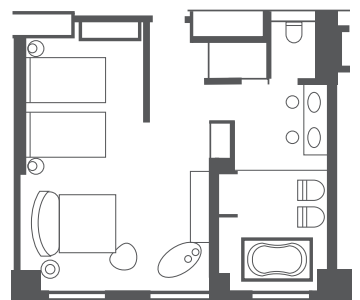

20F
|
18F

Premier Floor

A pendant light by the window illuminates a dignified and quiet setting.
Coordination full of transparency that expresses Japanese delicacy.



Large twin room

Large twin room

24 rooms

Room size/33.2㎡

Bed size/120cm×200cm

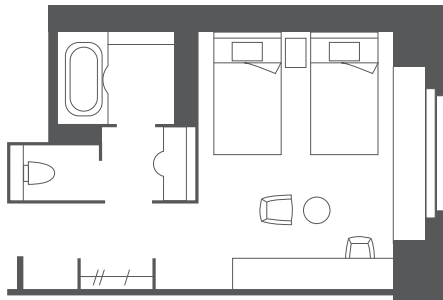

Twin room 16 rooms

Room size/24.3㎡

Bed size/110cm×200cm

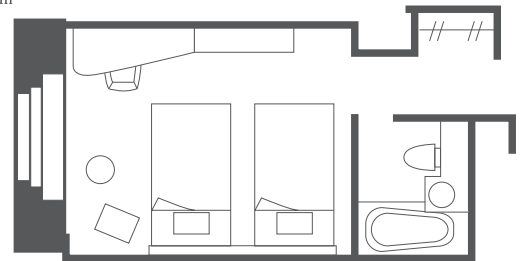

Queen double room

Queen double room 8 rooms

Room size/24.3㎡

Bed size/160cm×200cm

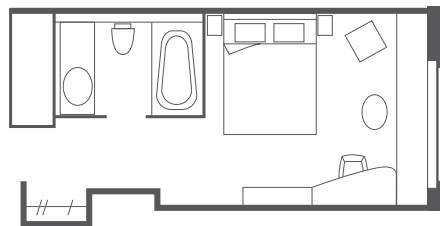

4 bed room

4 bed room 4 rooms

Room size/52.6㎡

Bed size/120cm×200cm

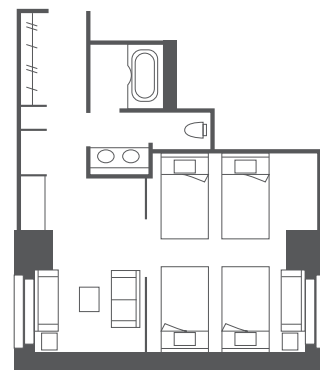

17F
|
15F

Comfort Floor

A space filled with soft warmth that will make you feel relaxed.
A guest room that expresses Hokkaido's generosity and calm.



Large twin room

Large twin room

24 rooms

Room size/33.2㎡

Bed size/120cm×200cm

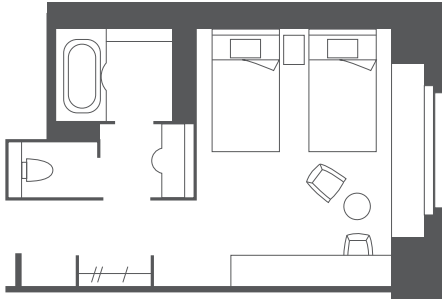

Queen double room

Twin room

20 rooms

Room size/24.3㎡

Bed size/110cm×200cm

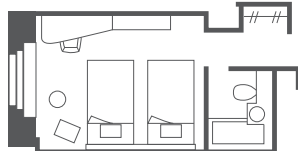

Queen double room

4 rooms

Room size/24.3㎡

Bed size/160cm×200cm

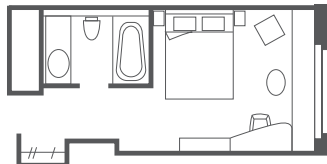

Single room

Single room

32 rooms

Room size/18.7㎡

Bed size/120cm×200cm

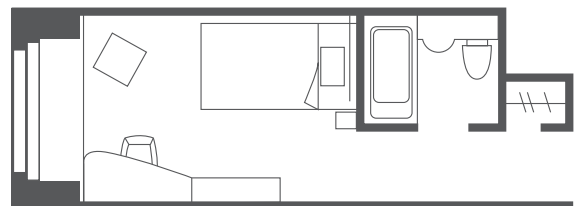

KEIO PLAZA HOTEL SAPPORO

14F
|
12F

Superior Floor

We create a clean and calm space with a sense of Japanese style.
A higher quality floor.



Queen double room

Queen double room 6 rooms
Room size/24.3㎡
Bed size/160cm×200cm

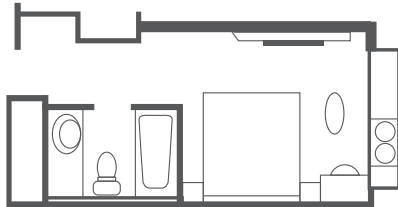

Double room

Double room 33 rooms
Room size/18.7㎡
Bed size/150cm×200cm

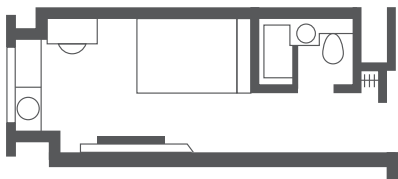

Triple room

Triple room 12 rooms
Room size/31.4㎡
Bed size/110cm×195cm



Large twin room 24 rooms
Room size/33.2㎡
Bed size/120cm×200cm

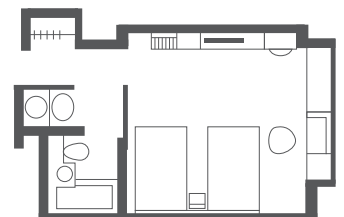



Large twin room

Large twin room 52 rooms
Room size/33.2㎡
Bed size/120cm×200cm



Twin room 56 rooms
Room size/24.3㎡
Bed size/110cm×200cm

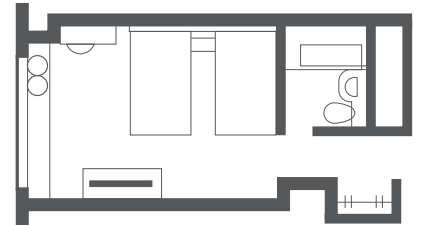

Family room

Family room 16 rooms
Room size/37.1㎡
Bed size/120cm×200cm×3
110cm×195cm×1

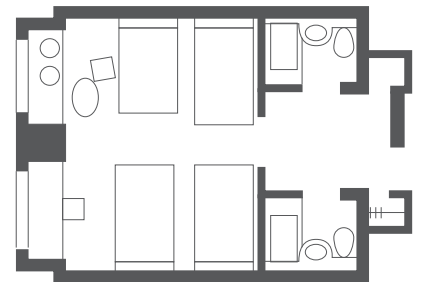

Accessible Room

Accessible Room 4 rooms
Room size/33.2㎡
Bed size/110cm×200cm
1 electrically reclining bed

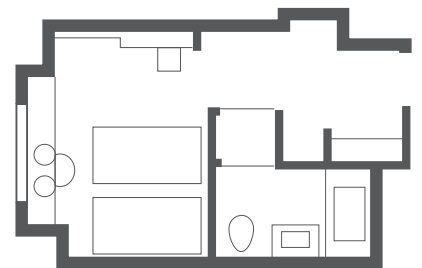

Club Lounge

Another soothing space



【Business hours】 13:00~21:00
Tea time 14:00~17:00
Bar time 17:00~21:00

A high-quality relaxing space located on the lobby floor exclusively for guests staying on the Premier・Luxury Floor. In the club lounge, you can enjoy Hokkaido-related soft drinks and baked sweets in a buffet style at all times. Additionally, a dedicated concierge will create a special stay for each guest.



Drink & Refreshments

Cafe drinks such as coffee, tea and selection of Hokkaido drinks. Besides baked sweets, sandwiches and fruit are available during tea time, and alcohol is available during bar time, so you can relax anytime.

Concierge Support

Resident concierge will be happy to assist you with reservations for restaurant and information on nearby tourist spots. We will make your stay more smooth and fulfilling.



Ovation echo on the celebratory stage.

Plaza hall Large banquet hall(Plaza hall)

B1

The ceiling height of the Plaza Hall is 8.1m, and the atrium extends from the B1 floor to the 1 floor above ground.

This is a multipurpose hall with sense of openness



Area / 538㎡ (163 per square)
Seating capacity / Dinner 270 people School 250 people
Buffet 300 people Theater 500 people



B1 Cherry room Medium banquet hall [Cherry room]

Use for exhibitions, buffet parties, etc.
Also use for memorial service.

Area / 145㎡ (44 per square)
Seating capacity / Dinner 90 people School 100 people
Buffet 100 people Theater 120 people
Buddhist memorial service 120 people
Buddhist memorial service + dinner for 90 people



B1 Suzuran Small banquet hall [Suzuran]

Please use it as a waiting room for important guests.
Area / 20㎡ (6 per square)

LAN and Wi-Fi connections are available in all banquet halls.

Stately space filled with pleasure

Eminence hall

Large banquet hall [Eminence hall]

2F

Eminence Hall is the main hall of Keio Plaza Hotel Sapporo. Capacity: 800 to 1,500 people
Use for a variety of purposes, weddings, international conferences, receptions, and various parties.



Area / 1,000m² (303 per square) Foyer 300m²
Seating capacity / Dinner 800 people School 100 people
Buffet 1,200 people Theater 1,500 people
※ Can be 2 divides



2F Foyer

Create a relaxing space with a feeling of openness that seems to expand forever and an original sofa and an arrangement of faintly glowing flower vases.

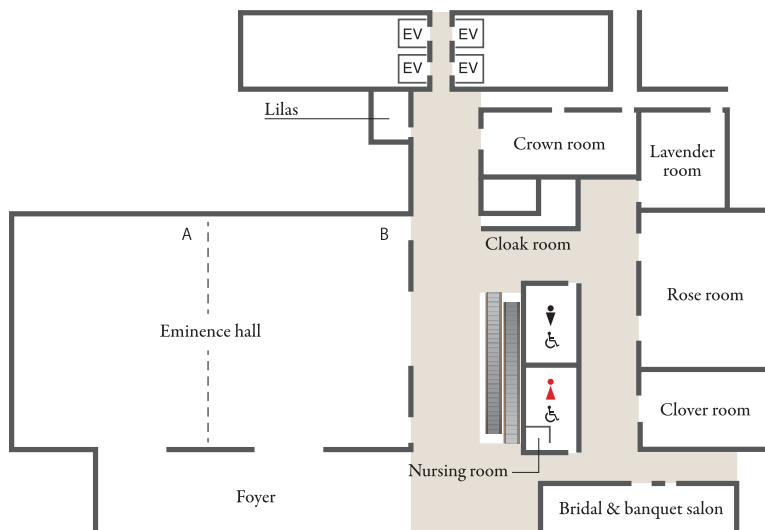

LAN and Wi-Fi connections are available in all banquet halls.

Warmth gently envelops a blissful time.

Rose room Medium banquet hall [Rose room]

The ROSE ROOM can host an elegant party.

You can enjoy a full-course dinner in a calm mood.

2F



Area / 200㎡ (61 per square)

Seating capacity / Dinner 100 people School 120 people
Buffet 120 people Theater 150 people



2F Clover room Small banquet hall [Clover room]

Use for a wide range of purposes, including corporate seminars, lectures, and various parties.

Area / 110㎡ (33 per square)

Seating capacity / Dinner 60 people School 80 people Buffet 70 people Theater 100 people



2F Lavender room Small banquet hall [Lavender room]

Use for multiple purposes such as buffet parties, exhibitions, and seminars.

Area / 91㎡ (28 per square)

Seating capacity / Dinner 50 people School 60 people Buffet 65 people Theater 80 people



2F Crown room Small banquet hall [Crown room]

You can enjoy at dinner, buffet-style parties, and second parties.

Area / 107㎡ (32 per square)

Seating capacity / Dinner 66 people School 54 people Buffet 70 people Theater 100 people

2F Lilas Waiting room [Lilas]

Important guests and VIPs can relax and unwind.

Please use as a waiting room for various ceremonies or for entertaining.

Area / 15㎡ (4 per square)

Seating capacity / 8 people



LAN and Wi-Fi connections are available in all banquet halls.



KEIO PLAZA HOTEL SAPPORO

Beautifully expressing the new formality.
MIYABI Medium banquet hall
 [MIYABI NO MA]

3F

[MIYABI NO MA] with stylish and modern coordination fits the latest wedding party. Furthermore, use at a wide range of events such as corporate and group gatherings and new product launches.

Area / 310㎡ (94 per square)
 Seating capacity / Dinner 200 people School 280 people
 Buffet 300 people Theater 350 people



Impress and leave a good impression on your guests.

OHGI Medium banquet hall
 [OHGINO MA]

3F

Just like the [MIYABI NO MA], the theme is stylish and modern, with a calming feel.

Use for a wide range of purposes, from New Year's parties to receptions and seminars.

Area / 310㎡ (94 per square)
 Seating capacity / Dinner 200 people School 280 people
 Buffet 300 people Theater 350 people



3F **KOTO** Small banquet hall [KOTO NO MA]

Accommodate variety of uses, including business meetings, dinners, and home parties.

Area / 310㎡ (94 per square)
 Seating capacity / Dinner 200 people School 280 people
 Buffet 300 people Theater 350 people



3F **FUE** Small banquet hall [FUE NO MA]

Heartwarming space perfect for small class meetings, various after-parties, dinner parties, etc.

Area / 73㎡ (22 per square)
 Seating capacity / Dinner 40 people School 45 people
 Buffet 60 people Theater 70 people

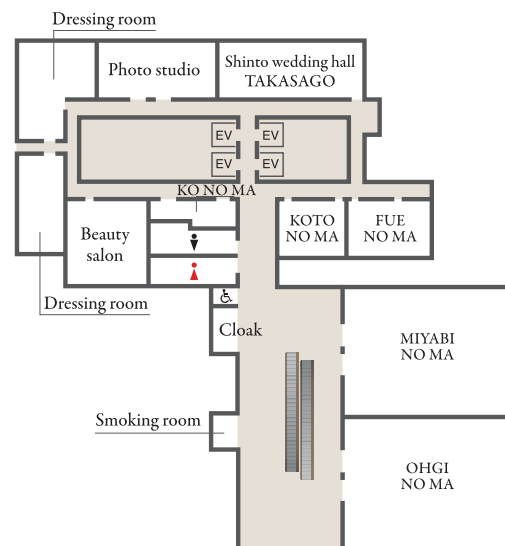

LAN and Wi-Fi connections are available in all banquet halls.





Japan's commitment to luxury.

Japanese style banquet hall **SOJUAN**

4F

The calm colors, lighting, and setting create a rich atmosphere. You can enjoy a relaxing meal at the sunken kotatsu seats. Please use it for a variety of occasions such as entertaining, auspicious events, and memorial services.

Seating capacity / ICHI NO MA (27 tatami mat) 40 people
 NI NO MA (20 tatami mat) 18 people



► ICHI NO MA

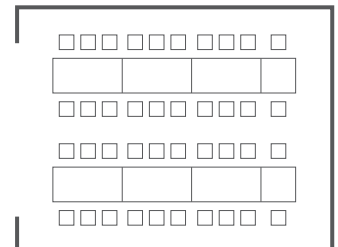

► NI NO MA

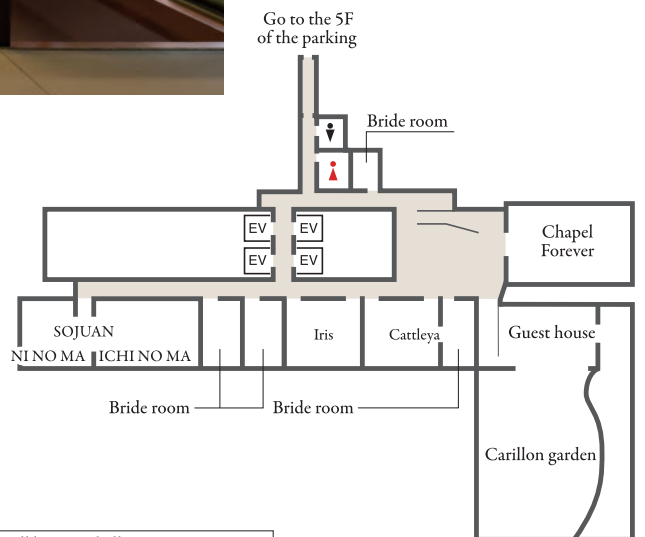
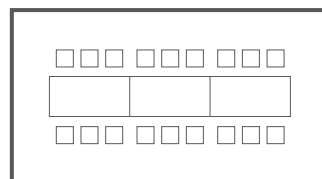

LAN and Wi-Fi connections are available in all banquet halls.

RESTAURANT & BAR

Encounter with seasonal flavors and the chef's special dishes bring smile to your face.
"You can enjoy delicious Hokkaido ingredients from restaurants to bars , where are wide variety of tastes and shops."
Please use for parties, business negotiations, dinner parties, after-parties, etc.



Enjoy the magnificent scenery of Hokkaido with all five senses.

TEPPAN-YAKI YAMANAMI

22F

TEPPAN-YAKI , located on the 22F , where you can enjoy the sparkling night view and the finest Hokkaido ingredients.

【Business hours】 Lunch 11:30-15:00 (L.O. 14:30) ※Please make reservation by 17:00 the day before your use date.
Dinner 17:00-22:00 (Last entry 20:30/L.O. 21:00)
※For enjoy your meal ,customers under elementary school age are not allowed to enter.

The beautiful scenery adds elegance to the taste.

Reservation required private room Japanese restaurant MIYAMA

Japanese restaurant where you can enjoy delicacies from Hokkaido's mountains , seas and seasonal ingredients from all over the country.

【Lunch (reservation required)】
【Business hours】 11:30-15:00 (L.O. 14:30) Regular holidays/Monday to Friday
※Open if Wednesday, Thursday, or Friday is a holiday.
【Dinner (reservation required)】
【Business hours】 17:00-21:30 (L.O. 21:00) Closed/Monday/Tuesday
※Please make reservations for lunch / dinner by 17:00 three days before your use date.

22F



Japanese space where you can enjoy Hokkaido's seasonal ingredients.

Robata Sushi KITANO MESHI AKIZU

B1

Japanese restaurant where you can enjoy seasonal Robotayaki and sushi.

【Business hours】 Lunch 11:30-14:30 (L.O. 14:30)
Dinner 17:00-22:00 (L.O. 21:00)

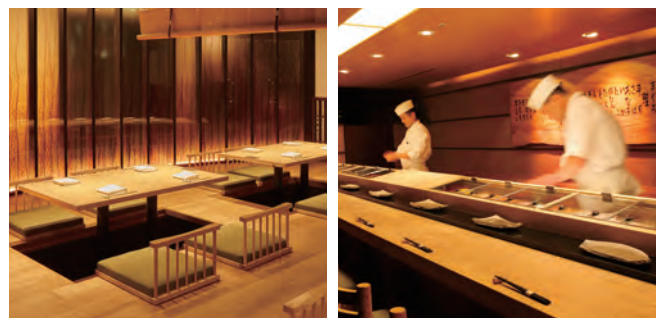



Buffet with a live feel and comfortable space.

Buffet & Party Court

【Glass seasons】

Lively buffet restaurant serving freshly prepared food.

【Business hours】 << Buffet >> 【Weekdays】 6:00~10:30 (L.O. 10:15) / 【Saturdays, Sundays, holidays】 6:00~11:30 (L.O. 11:15)
 << Cafe >> 10:00~14:30 (L.O. 14:00)

1F



The Hotel main bar seems to envelop visitors.

Main bar

【Cross vault】

The main bar has stately atmosphere, you can relax with stylish conversation and drinks.

【Business hours】 << Cafe >> 14:00~16:30 (L.O. 16:00)
 << Bar >> 17:00~23:30 (L.O. 22:30)

【Closed】 Sundays and holidays ※ Bar time only

1F



All of our bread and sweets products use 100% Hokkaido wheat.

Pastry Boutique

【Poppins】

We have selection of hotel-made sweets and breads, as well as items perfect for gifts.

【Business hours】 10:00-16:00 (bread sales start 11:00)

1F



RESTAURANT PRIVATE ROOM

《Information restaurant private rooms》

For special occasions such as important entertainment, dinner parties, and family celebrations, You can enjoy relaxing stay with reliable service.



FUJI NO MA



The beautiful scenery adds elegance to the taste.

Reservation required private room Japanese restaurant

MIYAMA

22F

Japanese restaurant where you can enjoy delicacies from Hokkaido's mountains, seas and seasonal ingredients from all over the country.

【Lunch (reservation required)】

【Business hours】 11:30-15:00 (L.O. 14:30) Regular holidays/Monday to Friday

※ Open if Wednesday, Thursday, or Friday is a holiday.

【Dinner (reservation required)】

【Business hours】 17:00-21:30 (L.O. 21:00) Closed/Monday/Tuesday

※ Please make reservations for lunch / dinner by 17:00 three days before your use date.



HAGI NO MA



KIRI NO MA



KAEDE NO MA



TAKE NO MA

Prepared private rooms that can accommodate various occasions such as family reunions, 60th birthday celebrations, etc. Private rooms have chairs or horigotatsu tables. Even elderly customers can use with confidence.

Private room fee

(tax and service charge included)

500 yen per person 2 hours of use, for junior high school students and above

Number of private rooms

- 4 horigotatsu rooms (up to 12 people)
- 3 chair seats rooms (up to 10 people)

- Private rooms are available for minimum of 2 people.
- Number of users varies depending on the private room, so please contact us for details.
- We also have meal plans (for 2 or more people) that include private room rates.
- Private room rates vary when used for meetings. Please contact us for more information.



KEIO PLAZA HOTEL SAPPORO

RESTAURANT PRIVATE ROOM

《Information restaurant private rooms》

For special occasions such as important entertainment, dinner parties, and family celebrations, You can enjoy relaxing stay with reliable service.



Japanese space where you can enjoy Hokkaido's seasonal ingredients.

Robata Sushi
KITANO MESHI **AKIZU**

B1

Japanese restaurant where you can enjoy seasonal Robatayaki and sushi.

【Business hours】 Lunch 11:30-14:30 (L.O. 14:30)
Dinner 17:00-22:00 (L.O. 21:00)

Enjoy variety of dishes made with Hokkaido ingredients tested by the head chef himself.
We have sushi counter, robatayaki counter, also have horigotatsu seats that can use as if you were in a private room.



ICHI



KIHADA

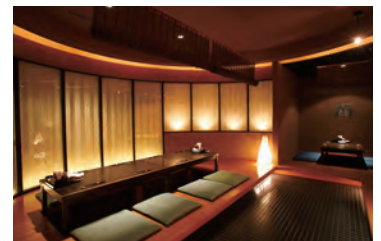

Private room fee
(tax and service charge included)

- ICHII (4 to 10 people) 3,630 yen
- KIHADA (6 to 14 people) 4,840 yen
- MIZUKI (10 to 20 people) 6,050 yen

- The fee for 2 hours for dinner, 1 hour for meeting.
- We also have meal plans that include private room rates.



MIZUKI

BREAKFAST

Enjoy nice breakfast to start your day

Collect the charms of Hokkaido that you can't help but eat

《Morning buffet》



Enjoy four seasons of Hokkaido with your eyes and tastes

《Japanese food set》



1F

Buffet & Party Court
【Glass seasons】

Standard Hokkaido cuisine, sushi made with Hokkaido vegetables and seafood, etc.

We offer a special plaza where you can eat as much as you want.

【Business hours】 Weekdays 6:00-10:30 (L.O.10:15)
Saturdays, Sundays, and holidays 6:00-11:30 (L.O. 11:15)

22F

Breakfast venue
【Pegasus】

Enjoy relaxing Japanese meals on the top floor of hotel overlooking the city of Sapporo.

You can enjoy the scenery changes with the four seasons and seasonal Hokkaido ingredients to your heart's content.

【Business hours】 7:00-10:00 (L.O. 9:45)



KEIO PLAZA HOTEL SAPPORO

Welcome to Keio Plaza Hotel Sapporo

For your comfortable stay
with our heartfelt service...

Keio Plaza Hotel Sapporo is located centrally in the Hokkaido city of Sapporo
- one of Japan's most popular tourist destinations.
Our dedicated staff welcome visitors from around the world with genuine hospitality,
providing high-quality service in a truly relaxing atmosphere.

ようこそ京王プラザホテル札幌へ。
あなたの快適な旅のひとつをお約束いたします。

京王プラザホテル札幌は、日本で観光地として人気の高い北海道の
札幌市にあるシティホテルです。
世界の国々から訪れるお客様を真心こめてお迎えし、
質の高いおもてなしと空間をご提供します。

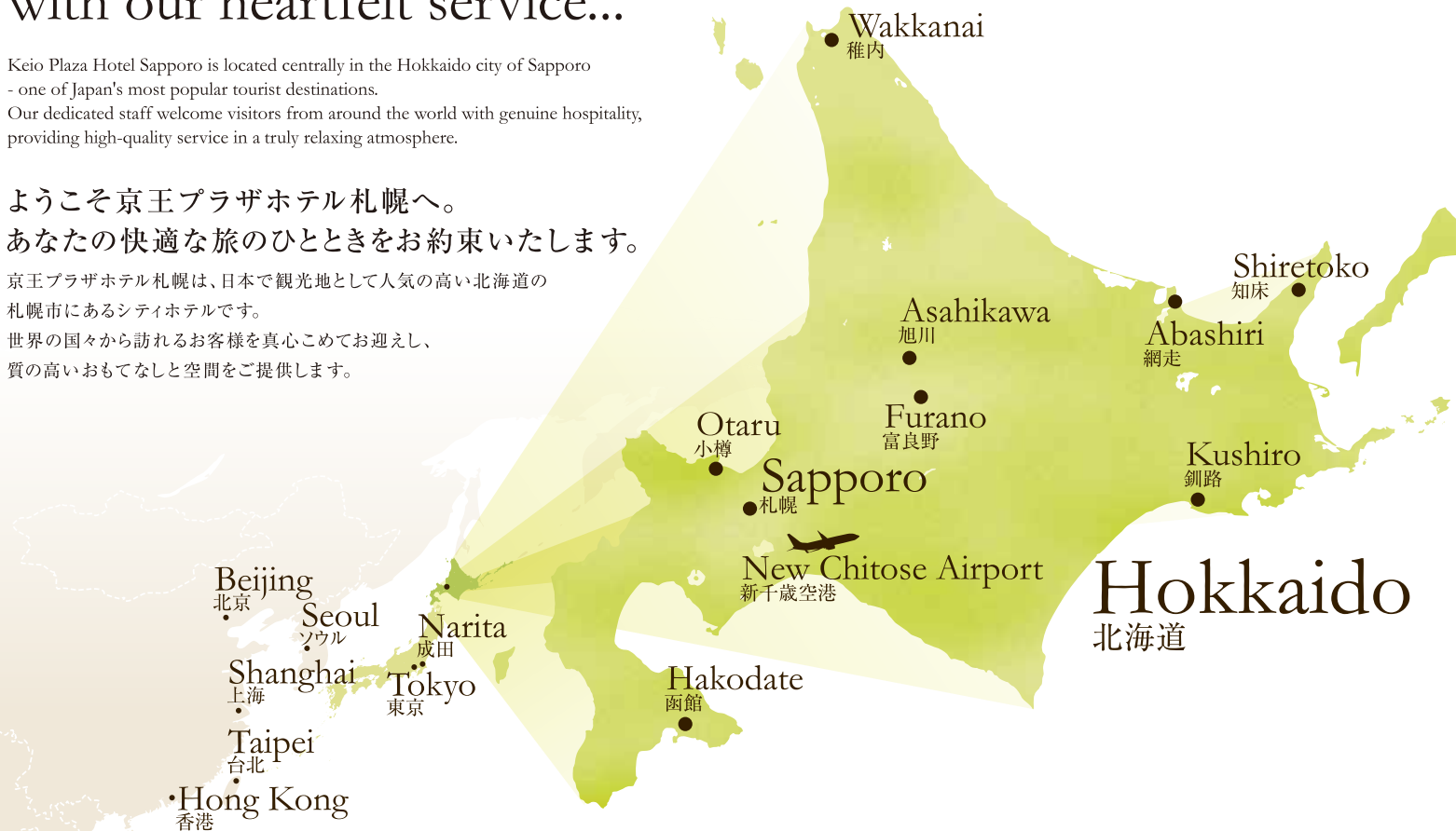

Access to Hokkaido

By Air - International 国際線で	From Bangkok	6h45min.	バンコクから	約6時間45分
	From Seoul	2h40min.	ソウルから	約2時間40分
	From Shanghai	3h15min.	上海から	約3時間15分
	From Beijing	3h50min.	北京から	約3時間50分
	From Hong Kong	4h50min.	香港から	約4時間50分
	From Taipei	3h50min.	台北から	約3時間50分
By Air - Domestic 国内線で	From Tokyo	1h30min.	東京から	約1時間30分
	From Narita	1h40min.	成田から	約1時間40分



Access from New Chitose Airport
新千歳空港からのアクセス

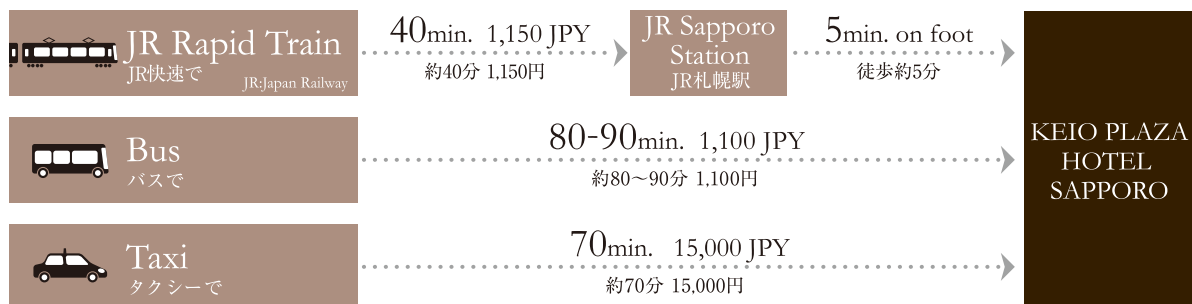

※Please note that travel times may vary and fares are subject to change. ※記載の所要時間や料金は変わる場合がございます。



KEIO PLAZA HOTEL SAPPORO